

Importance: High

Categories: Carly

Good Afternoon

We wish to provide you of advanced notice of our planned road works being carried out for our Barons Pastures development of Desford lane in Kirby Muxloe LE92BE.

From the **08/01/2024 – 21/01/2024 & 25/01/2024 – 16/02/2024**, we will be working within the highway on Desford Lane to install new drainage and footpaths for the development.

During these works there will be rolling temporary traffic lights within the highway on Desford Lane.

From the **17/02/2024 – 23/02/2024 (half Term Week)**, there will be a full road closure in place outside our development to enable the formation of the site entrance and highway re-surfacing.

During this period there will be a temporary diversion in place for all traffic.

I have attached a copy of our approved traffic management plans for the works for your reference.

During the above periods, please contact myself or our head office on the below contact details with any enquiries or complaints.

Kind regards

ANTHONY LEACH
Contracts Manager
Mercer Building Solutions

- anthony@mercerbuidingsolutions.com
- M: 07714 384014 | T: 01455 393100
- www.mercerbuidingsolutions.com
- Unit 4 The Coach House, Desford Hall, Leicester Lane, Desford, Leics, LE9 9JJ



Mercer Building Solutions Limited. Directors: FR Mercer, KJ Mercer. Registered Office: Unit 4 The Coach House, Desford Hall, Leicester Lane, Leicestershire, LE9 9JJ Tel: 01455 393100. Registered in England No. 8951382. www.mercerbuidingsolutions.com. This communication and any attachments are intended for the addressee(s) only. Please notify the sender if received in error. Unauthorised use or disclosure of the content may be unlawful. Internet email is not to be treated as a secure means of communication. Mercer Building Solutions Ltd has taken all reasonable steps to ensure no viruses exist within this email and any attachments, but cannot guarantee the contents are virus free and does not accept responsibility for any damage which might arise as a result of transmission to the recipient. It is the responsibility of the recipient to check that this email and any attachments are virus free.



⑤ SAFETY ZONE DIMENSIONS
 Permanent speed limit 60mph
 Sideways safety zone 1.2m
 Longways safety zone 60m
 (Dimensions are minima)

Specials -

**DESFORD LANE
 CLOSED AHEAD
 ACCESS LEFT
 BALDONS PARK CLASH**

DETAIL B ③

1) During closures, working signs to BS 681 120x325 2006 should be provided in accordance with Table A1.2 (Appendix 1).
 2) The signs should be placed in the following order:
 3) On the approach road (N/A) 400m with these dimensions. The cones will be staggered for each direction and staggered work.
 4) The signs should be placed in the following order:
 5) On the approach road (N/A) 400m with these dimensions. The cones will be staggered for each direction and staggered work.
 6) The signs should be placed in the following order:
 7) On the approach road (N/A) 400m with these dimensions. The cones will be staggered for each direction and staggered work.

DETAIL D ①

1) During closures, working signs to BS 681 120x325 2006 should be provided in accordance with Table A1.2 (Appendix 1).
 2) The signs should be placed in the following order:
 3) On the approach road (N/A) 400m with these dimensions. The cones will be staggered for each direction and staggered work.
 4) The signs should be placed in the following order:
 5) On the approach road (N/A) 400m with these dimensions. The cones will be staggered for each direction and staggered work.
 6) The signs should be placed in the following order:
 7) On the approach road (N/A) 400m with these dimensions. The cones will be staggered for each direction and staggered work.

Working Sign	Dimensions	Material
BS 681 120x325 2006	1200mm x 325mm	Aluminium
BS 681 120x325 2006	1200mm x 325mm	Aluminium
BS 681 120x325 2006	1200mm x 325mm	Aluminium
BS 681 120x325 2006	1200mm x 325mm	Aluminium
BS 681 120x325 2006	1200mm x 325mm	Aluminium
BS 681 120x325 2006	1200mm x 325mm	Aluminium
BS 681 120x325 2006	1200mm x 325mm	Aluminium
BS 681 120x325 2006	1200mm x 325mm	Aluminium
BS 681 120x325 2006	1200mm x 325mm	Aluminium
BS 681 120x325 2006	1200mm x 325mm	Aluminium

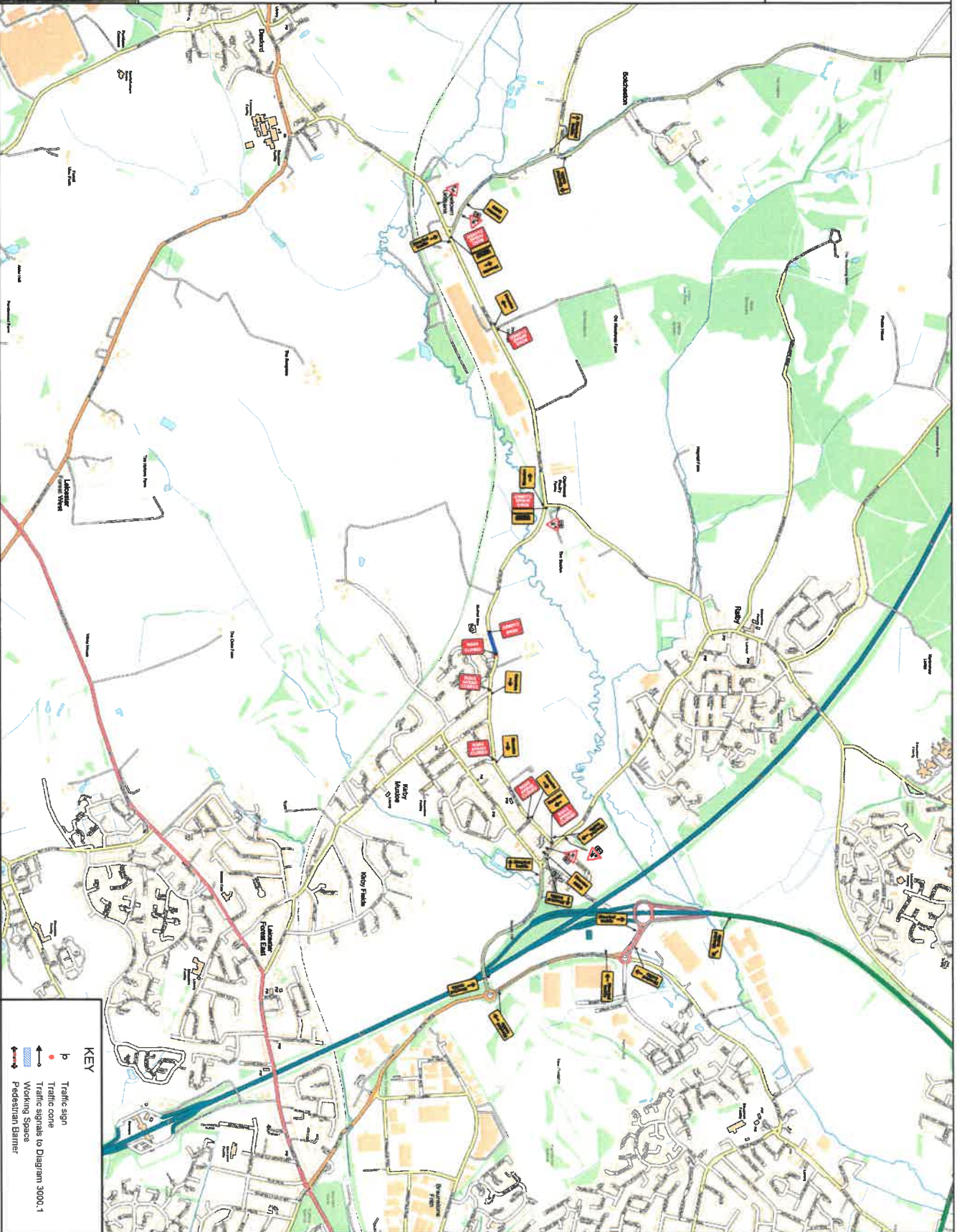

**TEMPORARY
 TRAFFIC MANAGEMENT
 PLAN**

Issue	Date	Drawn by
2	12/07/23	CT011

**ROAD CLOSURE + DIVERSION
 DESFORD LANE
 LEICESTER, LE9 2BE**

KEY

	Traffic sign
	Traffic cone
	Traffic signs to Diagram 3000.1
	Working Space
	Pedestrian Barrier

Drawing No - SZ0789a
LAMBERT CONSTRUCTION
 Original drawing site A3 - NTS



③ SAFETY ZONE DIMENSIONS
 Permanent speed limit 60mph
 Sideways safety zone 1.2m
 Longways safety zone 60m
 (Dimensions are minimal)

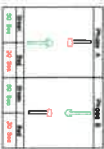

Minimum clear width between 'kerb' edge of footway and edge of safety zone
 Minimum clear width between 'kerb' edge of footway and edge of safety zone
 Minimum clear width between 'kerb' edge of footway and edge of safety zone
 Minimum clear width between 'kerb' edge of footway and edge of safety zone

DETAIL B
 Proposed permanent change of level - 400mm traffic cones, quantity 15m.
 Proposed permanent change of level - 750mm traffic cones, quantity 15m.
 Proposed permanent change of level - 750mm traffic cones, quantity 15m.
 Proposed permanent change of level - 750mm traffic cones, quantity 15m.

DETAIL D
 Proposed permanent change of level - 400mm traffic cones, quantity 15m.
 Proposed permanent change of level - 750mm traffic cones, quantity 15m.
 Proposed permanent change of level - 750mm traffic cones, quantity 15m.
 Proposed permanent change of level - 750mm traffic cones, quantity 15m.

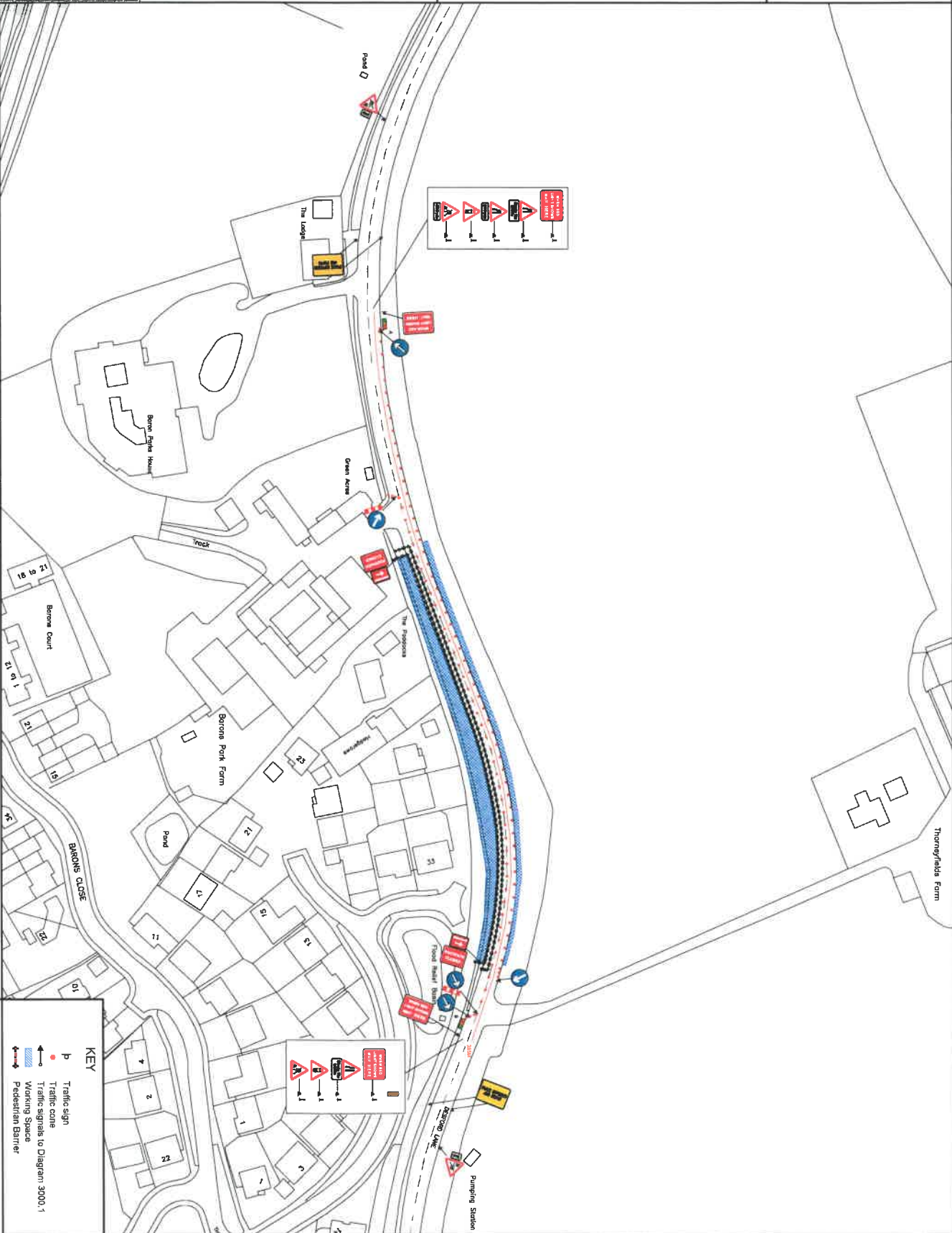

TEMPORARY
 TRAFFIC MANAGEMENT
 PLAN

Issue	1
Date	21/06/23
Drawn By	CT011

2 WAY TRAFFIC LIGHTS + PED MANAGEMENT
 DESFORD LANE
 LEICESTER, LE9 2BE

Drawing No - SZ0773a
 LAMBERT CONSTRUCTION
 Original drawing size A3 - NTS

KEY

- Traffic sign
- Traffic cone
- Traffic signs to Diagram 3000.1
- Warning Space
- Pedestrian Barrier